

ITEM NO.	PART NUMBER	DESCRIPTION	QTY.
1	TOY0010-00	CAMERA SPOTLIGHT	1
2	MTL0100-00	SPOTLIGHT MTG BRACKET - FLPR LEFT	1
3	PLS0036-00	44 LED LAYDOWN SOCKET	1
4	SMS0004-04	#4 x 1/4 PPH SMS ZINC (90190A106)	2
5	MAS0006-03	6-32 X 3/16 PPH MS ZINC	1
6	WIR0006-02P	2 PIN MOLEX MINI FIT JR CONNECTOR - PLUG	1

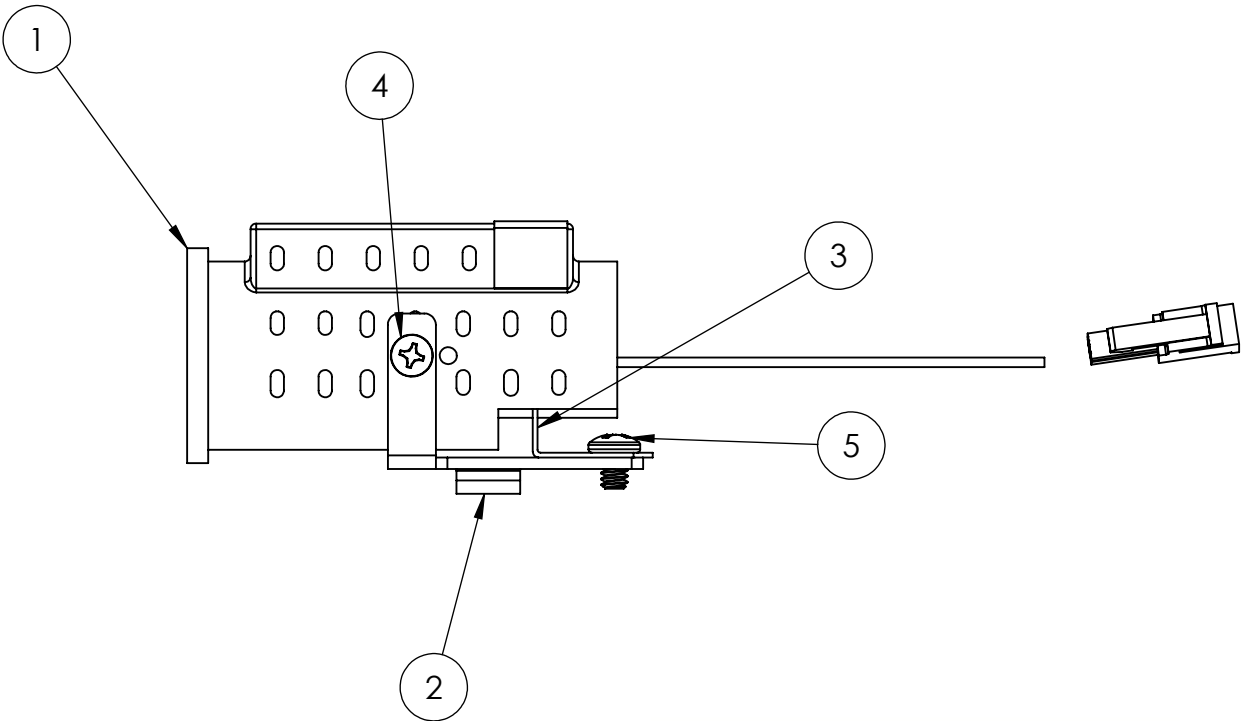
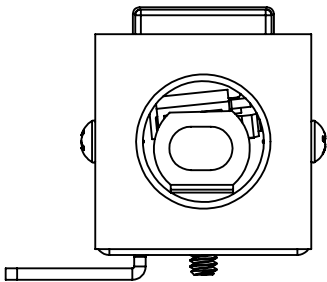
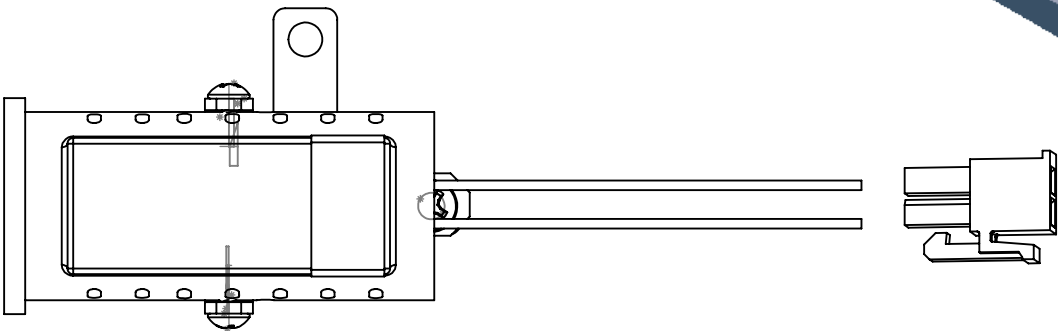
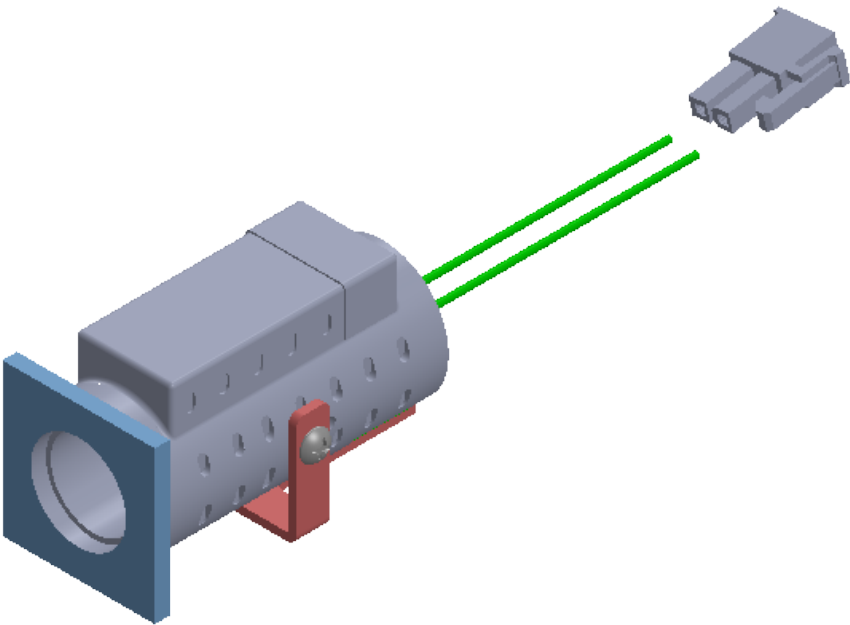

UNLESS OTHERWISE SPECIFIED: NO SHARP CORNERS AND EDGES. TOLERANCES:(DIMS ARE IN INCHES) ANGULAR: MACH ± .5 DEG BEND ± 1 DEG FRACTIONAL: ± .020 .X- ±.015 .XX- ±.010 .XXX- ±.005 .XXXX- ±.0001 FINISH 125RMS DO NOT SCALE DRAWING		<b>AMERICAN PINBALL</b> 1448 Yorkshire Dr. Streamwood, IL 60178	
MATERIAL: AS PER BOM		DESCRIPTION: SPOTLIGHT ASSY - FLPR LEFT	
FINISH: -		SIZE <b>B</b>	DWG. NO. ASM0035-00
DRAWN BY: ZR		DRAWN DATE: 7.13.2017	SCALE: 1:1
		SHEET 1 OF 1	